

Parts list for the **SP1-C CONSTRUCTION** 4-gallon Knapsack Sprayer

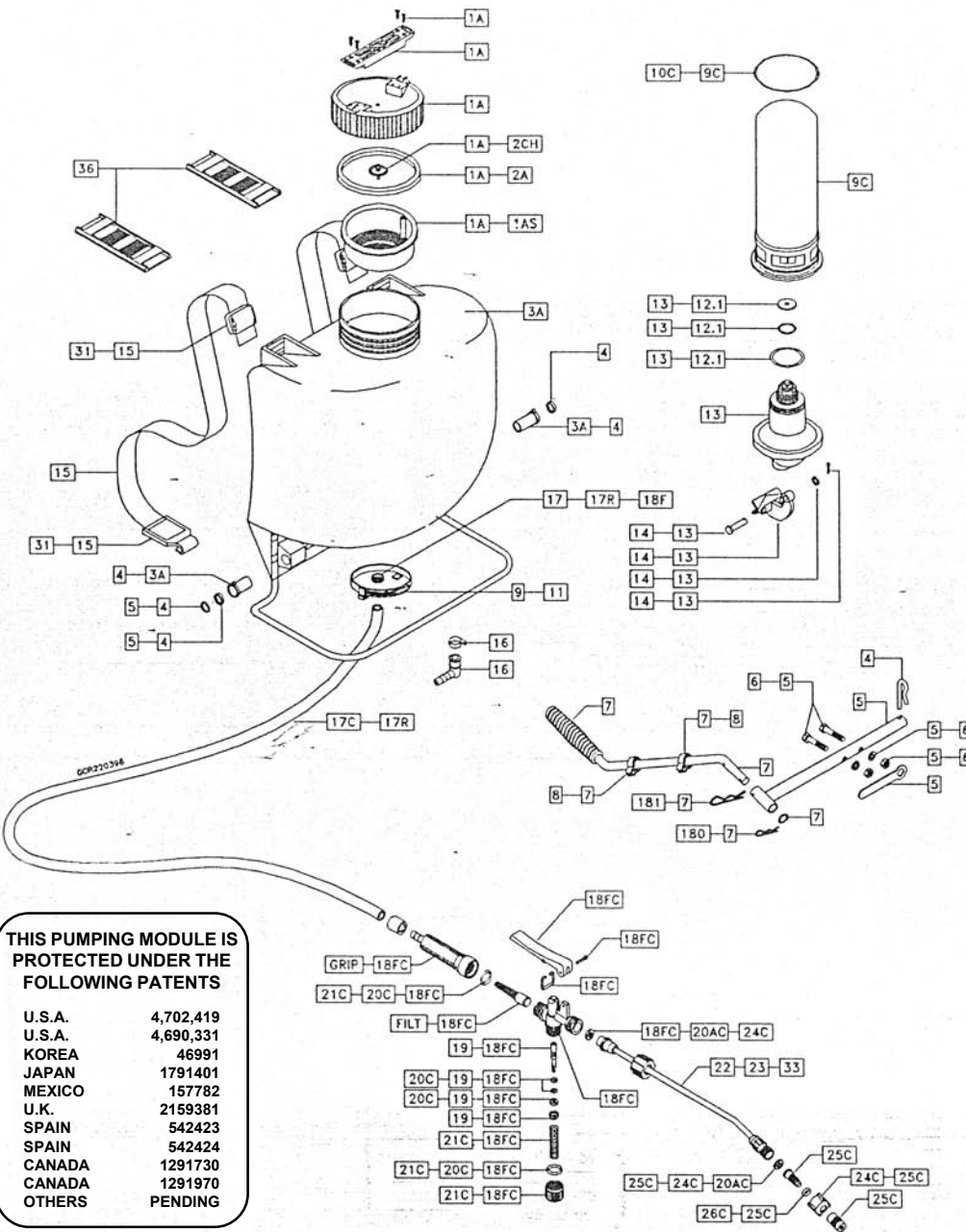

THIS PUMPING MODULE IS PROTECTED UNDER THE FOLLOWING PATENTS

| | |
|--------|-----------|
| U.S.A. | 4,702,419 |
| U.S.A. | 4,690,331 |
| KOREA | 46991 |
| JAPAN | 1791401 |
| MEXICO | 157782 |
| U.K. | 2159381 |
| SPAIN | 542423 |
| SPAIN | 542424 |
| CANADA | 1291730 |
| CANADA | 1291970 |
| OTHERS | PENDING |



For your convenience, you may order any and all spare parts from our parts depot:

SP Parts and Services, Inc.
(800) 286-0679



PO Box 7098, Santa Monica, CA 90406
(310) 449-1492 (800) 457-3440 FAX (310) 449-6912

| PARTS LIST | |
|-------------|--|
| Kit 1A | Cap w/seal & handle 6". |
| Kit 2A | Seal for cap 6". |
| Kit 2CH | Check valve for cap. |
| Kit 3A | Tank w/nylon bearing. |
| Kit 4 | Nylon bearing. |
| Kit 5 | Pump lever (fold-back type). |
| Kit 6 | Screw and nut set. |
| Kit 7 | Pump handle (fold-back type). |
| Kit 9C | Pressure tank. |
| Kit 10C | Pressure tank "O"ring. |
| Kit 11 | Retention clamp. |
| Kit 12.1 | Diaphragm "O"ring & washer set. |
| Kit 13 | Diaphragm pump module. |
| Kit 14 | Crank. |
| Kit 15 | Belt and clip. |
| Kit 16 | 90 degree fitting |
| Kit 17C | Hose set. |
| + Kit 17R | Hose set (rubber) |
| Kit 18FC | Complete spray pistol w/ built in filter & grip. |
| Kit 19 | Spindle set. |
| Kit 20C | Spindle "O"ring set. |
| Kit 20AC | Rubber washer. |
| Kit 21C | Plug set. |
| Kit 22 | Brass spray wand. |
| + Kit 23 | Plastic spray wand. |
| Kit 24C | Nozzle holder. |
| Kit 25C | Adjustable brass nozzle with holder. |
| + Kit 25JET | Plastic spray tip set (2-8004 & 1-TK5) |
| Kit 26C | Spray tip "O"ring set. |
| Kit 31 | Belt hooks. |
| + Kit 33 | Aluminum spray wand |
| Kit 36 | Shoulder pads. |
| Kit 180 | Locking pin-pump handle (small). |
| Kit 181 | Locking pin-pump handle (large). |
| Kit FILT | Filter for kit 18F & 18FC. |
| Kit GRIP | Grip handle for kit 18F & 18 FC. |

NOTE: + Not supplied with unit. See sheet of accessories.

NOTE:
For best results, the sprayer should be pumped every 5 seconds on a continuous basis. This will maintain your spraying pressure. If you do not pump, you will not have pressure to spray

If you have a question or a problem please call us at
1-800-457-3440
We will answer any question you may have.